

CONCEPTS  
&  
GENERAL INFORMATION

SUMMER 2024



## CONTENTS

General Information	<b>3</b>
Services	<b>4</b>
Accommodation	<b>5-6</b>
Rooms	<b>7 - 12</b>
Suite Concept	<b>13</b>
King Suite	<b>14</b>
Villa Concept	<b>15</b>
Deluxe Villa	<b>16 - 17</b>
Presidential Villa	<b>18 - 19</b>
Food & Beverage	<b>20 - 25</b>
Pools and Aquapark	<b>26-27</b>
Entertainment, Activities and Sports	<b>28</b>
Papy Kids Club	<b>29</b>
Papy Kids Sports Academy	<b>30</b>
Fitness Center	<b>31</b>
Fit Club & Private Lessons	<b>32</b>
Papillon Sports Center	<b>33</b>
Reborn Spa & Wellness	<b>34</b>
Meeting & Conference	<b>35</b>

Papillon Hotels reserves the right to change, correct and/or improve this information and/or the products, programs and/or services described at any time and without prior notice.





**PAPILLON**  
AYSCHA



# PAPILLON AYSCHA

5 Star | 60.000 m<sup>2</sup> | High Class - All Inclusive



## GENERAL INFORMATION

### Opening Date

2001

### President

Mr. H. Özgür Nazik

### General Manager

Mr. Deniz Çuha

### Sales & Marketing Director

Mr. Nida Kiraz

### Season

April - October

### Main Building

5 Floors - 4 Elevators

### Total Number of Rooms

363 / Main Building: 302 - Select

Villa: 56 - VIP Villa: 5

### Beach Condition

Sand

### Beach Length:

150 meters

### Languages

Turkish, German, English,

Russian, Arabic

### Credit Cards

Visa, Mastercard

### Early Arrival & Late Departure

Extra Charge

### Pets

Not allowed.

## TRANSPORTATION

### Antalya Airport

35 km

### Antalya City Center

40 km

### Nearest Settlement

Belek - 4 km

## E-MAIL

### Ayscha Center

ayscha@papillon.com.tr

### Spor Center

football@papillon.com.tr

### Sales & Marketing

sales@papillon.com.tr

### Europe Market

europe@papillon.com.tr

### BDT Market

cis@papillon.com.tr

## SOCIAL MEDIA / WEB

### YouTube

PapillonHotels

### Instagram

@papillonhotels

### Facebook

@PapillonHotelsLife

### Web Site

papillon.com.tr

### Linkedin

Papillon Hotels

### Telegram

@papillonhotels

## ADDRESS / PHONE

### Address

İleribaşı Mevkii - 07500

Belek - Antalya / TÜRKİYE

### Telephone

+90 242 710 12 00

### Fax

+90 242 710 12 30



## SERVICES

### FREE

- Rest area for early check-in/late check-out (Nautilus Lounge).
- 24-hour meal and beverage menu (Ayscha Martini Bar)
- Wi-Fi - Internet
- Mini Bar Service (Daily refills)
- Safe in the Rooms
- Baby Toilet, Bath and Crib
- Papy Kids Club / Kids Club
- Papy Kids Sports Academy
- Fit Club
- Fitness Centre
- Room service (Food and puree for 1-3 years old)
- Kids menu at all restaurants
- A la Carte Breakfast (25.05-30.09)
- Live Hosted Events
- Turkish Bath, Sauna and Steam Bath
- Beach and Pool Towels
- Sunbeds and Parasols
- Cold & hot beverage service at the pools, beach and pier
- Icebox (Water and Soda) next to the sunbed on the beach
- Wheelchair (Upon Availability)

### PAID

- Room Service (24 Hours) (Except for Deluxe Villa and Presidential Villa).
- Alcoholic and Non-Alcoholic beverages are not included in the High Class AI concept.
- Surf 'N Turf Restaurant
- Mikado Restaurant Teppanyaki
- Breakfast service by the pool in VIP Villas
- Telephone
- Laundry, Ironing and Dry-
- Cleaning Services
- Doctor and Health Care
- Reborn Spa & Wellness
- Baby- and child-sitter (1 – 12 years old and for availability)
- Stroller (5 € per day)
- Pasha Hookah Lounge
- Cabana service on the beach and in the pool.
- Special dinner upon the request of the guests.
- Water sports
- Billiards
- Car Rental
- Shopping Centre (hairdresser, market, boutique, watch-silver jewellery, optician, home textiles, jeweller, leather goods, souvenirs, shoes & bags, photography)
- Flower Delivery Service
- Butler service (150 € per day)
- Swimming, fitness and golf lessons.



# ACCOMODATION

## Room Comparisons

ROOMS	PLACE	VIEW	MAX. CAPACITY	BED ROOM	LIVING ROOM	BED CAPACITY	SHOWER & TUB	ROOM SIZE	TOTAL NUMBER
STANDARD ROOM	MAIN BUILDING	SEA & LAND	3 PERSON	1	-	1 Single + 1 Double	1+0	28 m <sup>2</sup>	265
HANDICAP ROOM	MAIN BUILDING	LAND	3 PERSON	1	-	1 Single + 1 Double	1+0	35 m <sup>2</sup>	3
EXECUTIVE ROOM	MAIN BUILDING	SEA & LAND	2 PERSON	1	-	1 Double	1+0	38 m <sup>2</sup>	12
FAMILY ROOM	MAIN BUILDING	LAND	6 PERSON (4+2)	2	-	2 Single + 2 Double	2+0	56 m <sup>2</sup>	8
CONNECTION FAMILY ROOM	MAIN BUILDING	SEA & LAND	6 PERSON (4+2)	2	-	2 Single + 2 Double	2+0	56 m <sup>2</sup>	10
KING SUITE	MAIN BUILDING	SEA	5 PERSON	2	1	2 Single + 1 Double	2+1	128 m <sup>2</sup>	4
SELECT FAMILY VILLA	GARDEN	POOL	4 PERSON (3+1)	1	1	1 Double + 2 Sofa	1+0	40 m <sup>2</sup>	56
DELUXE VILLA	GARDEN	GARDEN	7 PERSON (6+1)	3	1	2 Single + 2 Double	3+0	175 m <sup>2</sup>	4
PRESIDENTIAL VILLA	GARDEN	SEA & GARDEN	10 PERSON	5	1	2 Single + 4 Double	2+3	403 m <sup>2</sup>	1

# ACCOMODATION

## Room Types and Features

	STANDARD ROOM	HANDICAP ROOM	EXECUTIVE ROOM	FAMILY ROOM	CONNECTION FAMILY ROOM	KING SUITE	SELECT FAMILY VILLA	DELUXE VILLA	PRESIDENTIAL VILLA
Digital Safe	✓	✓	✓	✓	✓	✓	✓	✓	✓
Wireless Internet	✓	✓	✓	✓	✓	✓	✓	✓	✓
Direct Telephone Line	✓	✓	✓	✓	✓	✓	✓	✓	✓
LCD TV	✓	✓	✓	✓	✓	✓	✓	✓	✓
Mini Bar	✓	✓	✓	✓	✓	✓	✓	✓	✓
Tea & Coffee Station	✓	✓	✓	✓	✓	✓	✓	✓	✓
Shower Cabin	✓	✓	✓	✓	✓	✓	✓	✓	✓
Bathtub						✓			✓
Jacuzzi									✓
Bathrobes and Slippers	✓	✓	✓	✓	✓	✓	✓	✓	✓
Bathroom Amenities	✓	✓	✓	✓	✓	✓	✓	✓	✓
Hairdryer	✓	✓	✓	✓	✓	✓	✓	✓	✓
Balcony / Terrace	✓	✓	✓	✓	✓	✓	✓	✓	✓
Balcony Chair and Coffee Table	✓	✓	✓	✓	✓	✓	✓	✓	✓
Parasol							✓	✓	✓
Garden							✓	✓	✓
Pool							✓	✓	✓
Sunbed							✓	✓	✓
Split Air Conditioner						✓	✓	✓	✓
Central Air Conditioner	✓	✓	✓	✓	✓	✓			
Espresso Machine						✓		✓	✓
Maxi Bar						✓		✓	✓
Iron and Ironing Board						✓		✓	✓



# STANDARD ROOM

Land-Sea View | Main Building | 265 Rooms. | 28 m<sup>2</sup>

## Maximum Capacity

- 3 Persons

## Properties

- Laminate Floor
- Bedroom:  
Double bed (160x200 cm)  
Single bed (100x200 cm)
- Bathroom
- Balcony

## Bathroom

- Shower stall
- Bathrobes and Slippers
- Bathroom Amenities

## Technology

- Digital Safe
- Wireless Internet
- LCD TV
- Central Air Conditioning
- Telephone

## Services

- Kettle
- Mini Bar (Daily Refills)
- Pillow Menu





# HANDICAP ROOM

Land View | Main Building | 3 Rooms | 30 m<sup>2</sup>

## Maximum Capacity

- 3 Persons

## Properties

- Laminate Floor
- Bedroom:
  - Double bed (160x200 cm)
  - Single bed (100x200 cm)
- Bathroom
- Balcony

## Bathroom

- Shower stall
- Bathrobes and Slippers
- Bathroom Amenities

## Technology

- Digital Safe
- Wireless Internet
- LCD TV
- Central Air Conditioning
- Telephone

## Services

- Kettle
- Mini Bar (Daily Refills)
- Pillow Menu







# EXECUTIVE ROOM

Land-Sea View | Main Building | 12 Rooms | 40 m<sup>2</sup>

## Maximum Capacity

- 2 Persons

## Properties

- Laminate Floor
- Bedroom:  
Double bed (180x200 cm)
- Bathroom
- Balcony

## Bathroom

- Shower stall
- Bathrobes and Slippers
- Bathroom Amenities

## Technology

- Digital Safe
- Wireless Internet
- LCD TV
- Central Air Conditioning
- Telephone

## Services

- Kettle
- Mini Bar (Daily Refills)
- Pillow Menu





# FAMILY ROOM

Land View | Main Building | 8 Rooms | 56 m<sup>2</sup>

## Maximum Capacity

- 6 Persons (4+2)

## Properties

- Laminate Floor
- 2 Bedrooms: in each bedroom 1 Double bed (160x200 cm) and 1 Single bed (100x200 cm)
- Intermediate Door
- 2 Bathrooms
- 2 Balconies

## Bathroom

- Shower stall
- Bathrobes and Slippers
- Bathroom Amenities

## Technology

- Digital Safe
- Wireless Internet
- LCD TV
- Central Air Conditioning
- Telephone

## Services

- Kettle
- Mini Bar (Daily Refills)
- Pillow Menu





# CONNECTION FAMILY ROOM

Land-Sea View | Main Building | 10 Rooms | 56 m<sup>2</sup>

## Maximum Capacity

- 6 Persons (4+2)

## Properties

- Laminate Floor
- 2 Bedrooms: in each bedroom 1 Double bed (160x200 cm) and 1 Single bed (100x200 cm)
- Intermediate Door
- 2 Bathrooms
- 2 Balconies

## Bathroom

- Shower stall
- Bathrobes and Slippers
- Bathroom Amenities

## Technology

- Digital Safe
- Wireless Internet
- LCD TV
- Central Air Conditioning
- Telephone

## Services

- Kettle
- Mini Bar (Daily Refills)
- Pillow Menu





# SELECT FAMILY VILLA

Pool View | Garden | 56 Rooms | 40 m<sup>2</sup>

## Maximum Capacity

- 4 Persons (3+1)

## Properties

- Ceramic Floor
- Bedroom: Double bed (180x200 cm)
- Living Room: 2 Couches (75x210 cm)
- Bathroom
- Balcony

## Bathroom

- Shower stall
- Bathrobes and Slippers
- Bathroom Amenities

## Technology

- Digital Safe
- Wireless Internet
- LCD TV
- Central Air Conditioning
- Telephone

## Services

- Kettle
- Mini Bar (Daily Refills)
- Pillow Menu
- Capsule Coffee Machine





## Special VIP privileges for our King Suite guests.

- Express Check-in and Late Check-out service is available when possible.
- VIP welcome (Champagne); guests escorted to their room by Guest Relations.
- Special WhatsApp assistant service is available for guests.
- The satisfaction of VIP suite guests is monitored daily by Guest Relations.

- Check-in Day VIP Setup:

*Macaron, seasonal fruits, Toblerone chocolate, Beefeater Gin, Wine (Red – White), Tallero Frizzante Secco.*

- Daily VIP Suite Mini Bar Refill:

*Coca Cola, Fanta, Sprite, Water, Soda, Fruit Juices, Chocolate Milk and Plain Milk, Local and Imported Beers (Efes, Budweiser, Miller), Various Teas and Coffee (Capsules), Sweet and Salty Snacks (Minibar is replenished once a day free of charge)*

- A la Carte usage right is unlimited, but a reservation is required.
- Daily Turndown Service is provided.
- Special discounts are applied for spa services.

**Important Note:** Some beverage brands may not be available or may be substituted due to seasonal demand, and/or import challenges encountered by the supplier company.



*Suite Concept*

## KING SUITE

Sea View | Main Building | 4 Rooms | 128 m<sup>2</sup>

### Maximum Capacity

- 5 Persons

### Properties

- Laminate Floor
- 2 Bedrooms: in one bedroom 1 Double bed (180x200 cm) and in the other bedroom 2 Single beds (100x200 cm)
- Living Room
- 2 Bathrooms
- Balcony

### Bathroom

- Shower stall
- Bathtub
- Bathrobes and Slippers
- Bathroom Amenities

### Technology

- Digital Safe
- Wireless Internet
- LCD TV
- Central Air Conditioning
- Telephone

### Services

- Kettle
- Mini Bar (Daily Refills)
- Pillow Menu
- Capsule Coffee Machine





# Villa Concept

## Special VIP privileges for Presidential & Deluxe Villas guests

- Express Check-in and Late Check-out service is available when possible.
- VIP welcome (flower bouquet, champagne); guests escorted to their room by Guest Relations.
- Special WhatsApp assistant service is available for Villa Guests.
- The satisfaction of Villa guests is monitored daily by Guest Relations.
- Check-in Day VIP Setup:  
*Macaron, baklava, seasonal fruits, Toblerone chocolate, Beefeater Gin, Martell V.S., Wine (Red-White-Rose), Chivas 12 Whiskey, Absolut Vodka, and Champagne.*
- Daily Villa Mini Bar Refill:  
*Coca Cola, Fanta, Sprite, Water, Soda, Fruit Juices, Chocolate and Plain Milk, Local and Imported Beers (Efes, Budweiser, Miller), Energy Drinks, Various Teas and Coffee (Capsules), Sweet and Salty Snacks (Minibar is replenished once a day for free)*
- 24/7 Free Room Service
- A la Carte usage right is unlimited, but a reservation is required.
- Free cabana service is provided throughout the stay.
- BBQ service is provided in the villa once per 7 night stay.
- Daily Turndown Service is provided.
- Free laundry service (except dry cleaning) is provided.
- Fresh beach towels are placed on the sun lounger on the room terrace daily.
- Villa guests have the right to use our other Papillon facilities.
- Special discounts are applied for spa services.
- Butler service (150 € per day)  
*Butler working hours: 09:00-23:00*
- Butler Duties:  
*All food and beverage orders are taken.  
In-hotel and out-of-hotel reservation services are provided.  
Full service is provided for special organizations and for your daily needs.  
Can be found in the villa upon request or can be reached by phone.*

**Important Note:** Some beverage brands may not be available or may be substituted due to seasonal demand, and/or import challenges encountered by the supplier company.



*Villa Concept*

## DELUXE VILLA

Pool View | Garden | 4 Villas | 175 m<sup>2</sup>

### Maximum Capacity

- 7 Persons (6+1)

### Properties

- Ceramic Floor + Carpet
- 3 Bedrooms: on the ground floor in one bedroom 1 Double bed (160x200 cm); on the upper floor in one bedroom 1 Double bed (180x200 cm); on the upper floor in the other bedroom 2 Single beds (100x200 cm)
- Living room
- Kitchen

- Terrace + Garden
- 3 Bathrooms
- 2 Balconies
- Private Pool (heated on request)

### Bathroom

- Shower stall
- Bathrobes and Slippers
- Bathroom Amenities

### Kitchen

- Dinner table
- Refrigerator
- Dishwasher
- Washing machine

- Microwave oven

### Technology

- Digital Safe
- Wireless Internet
- LCD TV
- VRV Air Conditioning System
- Telephone

### Services

- Kettle
- Mini Bar (Daily Refills)
- Room service
- Pillow Menu
- Iron and Ironing Board
- Capsule Coffee machine







*Villa Concept*

## DELUXE VILLA

Pool View | Garden | 4 Villas | 175 m<sup>2</sup>





# PRESIDENTIAL VILLA

Sea-Pool View | Garden | 1 Villa | 403 m<sup>2</sup>

## Maximum Capacity

- 10 Persons

## Properties

- Laminate, ceramic and marble floors
- 5 Bedrooms: On the ground floor: in the first bedroom 1 Double bed (160x200 cm); in the second bedroom 2 Single beds (100x200 cm); On the upper floor: in the first bedroom 1 Double bed (200x200 cm); in the second bedroom 1 Double bed (160x200 cm) & in the third bedroom 1 Double bed (160x200 cm).
- Living room
- Fitness and Playground (Billiard)

- Kitchen
- Terrace
- Garden
- 5 Bathrooms
- 2 Balconies
- Private Pool (heated on request)

## Bathroom

- 3 Shower Stalls
- 3 bathtubs
- Jacuzzi
- Sauna
- Bathrobes and Slippers
- Bathroom Amenities

## Kitchen

- Refrigerator
- Dishwasher

- Washer and Dryer
- Microwave oven

## Technology

- Digital Safe
- Wireless Internet
- LCD TV
- VRV Air Conditioning System
- Telephone

## Services

- Kettle
- Mini Bar (Daily Refills)
- Room service
- Pillow Menu
- Iron and Ironing Board
- Capsule Coffee machine





*Villa Concept*

## PRESIDENTIAL VILLA

Sea-Pool View | Garden | 1 Villa | 403 m<sup>2</sup>





## FOOD & BEVERAGE

- The main restaurant concept offers buffet-style dining with dishes from world cuisines and interactive cooking corners for breakfast, lunch, and dinner.
- The main restaurant has a children's buffet, a food preparation corner, a wellness corner, and live cooking corners.
- 3 types of freshly squeezed fruit and vegetable juices are served in the Main Restaurant and the vitamin bar (Fruit and vegetables may vary according to the season).
- In the main restaurant, smoothies are served from the smoothie service bar during the morning breakfast service.
- Baby high chairs are available in the main restaurant and all other A la Carte restaurants.
- All drinks are served to the table.
- Local or imported original brands are used in all food and beverages.
- Upon request, special food requests can be prepared for guests with specific allergies in all our restaurants, if they specify in advance.
- All drinks not included in the concept (champagne, bottled wine and luxury alcoholic drinks, etc.) are served at an additional fee.
- Free food and beverage is offered 24/7 in our lounge areas.

### GENERAL DINING AREAS

Restaurant	Kitchen	Concept	Working Hours	Location	Capacity	Paid	Free
Angora Main Restaurant	International Cuisine & Children's Buffet Turkish Corner Asian Corner (Origin Chef) Indian Corner (Origin Chef) Seafood Corner	Breakfast Lunch Dinner Night Buffet	07:00 - 10:30 12:30 - 14:30 18:30 - 21:00 23:00 - 00:00	Main Building	770 Pax	-	✓

### OTHER FOOD SERVICES

Restaurant	Kitchen	Concept	Working Hours	Location	Capacity	Paid	Free
Martini Lounge Bar	International	All Day Dining	7 / 24	Main Building	66 Pax	-	✓
Room Service	International	Breakfast Lunch Dinner	7 / 24	Main Building	-	✓	-



## A LA CARTE BREAKFAST & LUNCH & SNACK FOOD SERVICES

Restaurant	Kitchen	Concept	Working Hours	Location	Capacity	Paid	Free
Beach Lawn Area	Gözleme Fruit Ice Cream Donuts & Bagels	Fast Food	11:00 - 18:00 11:00 - 18:00 10:30 - 18:00 16:00 - 18:00	Beach	-	-	✓
Pool Bar	Hot Dog	Fast Food	16:00 - 18:00	Pool	-	-	✓
Cafe Harmony	International	Patisserie	10:00-21:00	Main building	17 Pax	-	✓
PA&CO	International	Pastry & Bakery	10:00 - 22:00	Pool / Terrace	30 Pax	-	✓
Viccolo (25.05-30.09)	International	Ala Carte Breakfast	08:00 - 10:30	Garden	50 Pax	-	✓
Viccolo	Comfort Food	Snack Buffet	12:00 - 15:30	Garden	36 Pax	-	✓
Coral	Comfort Food	Snack Buffet	12:00 - 15:30	Garden	46 Pax	-	✓
Taco (15.04-15.10)	Comfort Food	Ala Carte Snack	12:00 - 15:30	Select Villa	48 Pax	-	✓
Mikado (01.06-31.10)	Far East (Bento)	Ala Carte Lunch	12:00 - 15:30	Main Building	40 Pax	-	✓

Villa Snack Restaurant



Beach Snack Restaurant



Nautilus Lounge



## EVENING A LA CARTE SERVICES

Restaurant	Kitchen	Concept	Working Hours	Location	Capacity	Paid	Free
Surf & Turf	Steak & Seafood	Ala Carte Dinner	18:30 - 21:30	Main Building & Terrace	32 Pax	25 €	-
Safran	Modern Turkish	Ala Carte Dinner	18:30 - 21:30	Main Building	40 Pax	-	✓
Mikado	Far East	Ala Carte Dinner	18:30 - 21:30	Main Building	50 Pax	-	✓
Mikado	Teppanyaki	Ala Carte Dinner	18:30 - 21:30	Main Building	12 Pax	-	✓
Coral (15.04-31.10)	Fish & Seafood	Ala Carte Dinner	18:30 - 21:30	Beach	70 Pax	-	✓
Viccolo (01.05-31.10)	Italian	Ala Carte Dinner	18:30 - 21:30	Beach	50 Pax	-	✓
Taco (01.05-15.10)	Mexican	Ala Carte Dinner	18:30 - 21:30	Select Villa Area	40 Pax	-	✓

### Dinner service rules in our A la Carte Restaurants are as follows;

Reservations are required for all à la carte restaurants, including those in villa accommodations.

### Within the Concept, the dinner service rules in place in our A la Carte Restaurants are as follows:

- For stays of 3-7 nights, 1 A la Carte Restaurant and 1 Breakfast A la Carte use per person are included.
- For 8-15 night stays, 2 A la Carte Restaurants and 1 Breakfast A la Carte uses are included.
- For 16+ accommodation, 3 A la Carte Restaurants and 2 Breakfast A la Carte uses are included.

### Important notes:

- SURF 'N TURF restaurant is paid (25 Euros per person).
- Extra products to be selected from the SURF 'N TURF restaurant menu will be charged at the daily market price.
- The Teppanyaki section in MIKADO Restaurant is chargeable according to the selected set menu.
- No reservation is required in our A la Carte restaurants at noon.
- Additional A la Carte usage is 20 € per person. 50% discount applies to children.
- Domestic & foreign luxury alcoholic beverages not included in the concept will be served for an additional fee.
- Some beverage brands may not be available or may be substituted due to seasonal demand, and/or import challenges encountered by the supplier company.

### General Warning:

Papillon Hotels & Resorts reserves the right to close A la carte restaurants and similar venues for certain times due to insufficient guest demand, unsuitable weather conditions or similar operational reasons.

Coral A la Carte



Safran A la Carte



Viccolo A la Carte





## BEVERAGE SERVICES

Bar & Lounge	Service Type	Concept	Working Hours	Location	Capacity	Paid	Free
Lobby Bar	A la Carte Service	High Class	24 Hours	Main Building Terrace	152 Pax	-	✓
Martini Lounge Bar	A la Carte Service	High Class	24 Hours	Main Building	218 Pax	-	✓
Wine Cellar	-	-	24 Hours	Main Building	-	✓	-
Beach Bar	Beach Service & Self Service	High Class	10:00 - 18:00	Beach	40 Pax	-	✓
Select Villa Pool Bar (15.04-15.10)	Poolside Service & Self Service	High Class	10:00 - 18:00	Select Villa Zone	50 Pax	-	✓
Pool Bar	Poolside Service & Self Service	High Class	10:00 - 23:00	Pool	400 Pax	-	✓
Harmony Patisserie	Self Service	High Class	10:00 - 18:00	Main Building	17 Pax	-	✓
PA&CO	A la Carte Service & Self Service	High Class	10:00 - 22:00	Pool / Terrace	24 Pax	-	✓
Pasha Lounge	A la Carte Service	-	13:00 - 00:00	Pool / Terrace	24 Pax	✓	-
Disco Bar	A la Carte Service & Self Service	High Class	23:00 - 02:00	Main Building & Beach	40 Pax	-	✓

\* Beverage Service to sunbeds, from QR menus at Select Pool, Main Pool, Children's Pool, Beach and Pier. Also, Icebox, Pet Water and Soda Service in Main Pool, Children's Pool, Beach and Pier between sunbeds.

**Martini Bar - Terrace**



**Disco Bar**



**Pool Bar**



## GENERAL BEVERAGE CONCEPT

BEVERAGE LIST	PLACE	FREE
<p><b>Wine:</b> SUVLA (White, Red, Rose)</p> <p><b>Sparkling Wine:</b> Amor (White, Rose)</p> <p><b>Aperitif + Digestif + Bitters:</b> Bianco Vermouth, Dry Vermouth, Sweet Vermouth, Grappa, Sake, Campari, Aperol, Aperitivo, Jägermeister, Fernet Branca, Ramazzotti Amaro</p> <p><b>Beer:</b> Efes Pilsen, Bomonti, Beck's, Budweiser, Nonalcoholic Beer</p> <p><b>Vodka:</b> Absolut, Gilbey's, Smirnoff, Russian Standard, Zubrowka Bison Grass, Belvedere</p> <p><b>Rum:</b> Captain Morgan White, Captain Morgan Gold, Bacardi, Havana Club 3 years old, Janeiro Cachaça</p> <p><b>Gin:</b> Gilbey's, Gordon's, Gordon's Pink, Beefeater, Beefeater Strawberry, Tanqueray, Tanqueray Flor De Sevilla, Bombay Sapphire</p> <p><b>Tequila:</b> Sierra, Olmeca Silver, Olmeca Gold, Olmeca Dark Chocolate</p> <p><b>Raki:</b> Efe Göbek, Efe Gold, Efe Yaş Üzüm, Yeni Rakı, Yeni Rakı Yeni Series, Yeni Rakı Ala, Yeni Rakı Ustalar Mixture, Yeni Rakı Long Brew, Tekirdağ, Tekirdağ Altın Series, Tekirdağ Roasted Anise, Kulüp, Altınbaş, Sarı Zeybek, Mercan, Beylerbeyi Göbek</p> <p><b>Whisky:</b> Vat 69, Bells, Ballantine's Finest, J&amp;B Rare, JW Red Label, JW Black Label, JW Double Black, JW Gold Label, JW 18 years old, Famous Grouse, Dimple Golden Selection, Chivas Regal 12 Years Old, Chivas Regal 15 Years Old, Chivas Regal 18 Years Old, Monkey Shoulder, Glenlivet Founder's Reserve(SINGLE MALT), Singleton 12(SINGLE MALT), Cardhu(SINGLE MALT), Glenmorangie 10 Original(SINGLE MALT), Glenmorangie X(SINGLE MALT), Ardbeg Wee Beastie(SINGLE MALT), Jim Beam, Bulleit Bourbon, Jack Daniel's, Gentleman Jack, Jack Daniel's Apple, Jack Daniel's Fire, Jameson, Jameson Caskmates</p> <p><b>Brandy:</b> Sorau Brandy, Napoleon, ST Remy VSOP, Martell VS</p> <p><b>Liquor:</b> Irish Cream, Peach, Mint, Coffee, Orange, Orange, Bitter Almond, Coconut, Tropical, Limoncello, Gum Drop, Maraska Cherry</p> <p><b>Soft Drinks:</b> Coca Cola, Coca Cola Zero, Fanta, Sprite, Iced Tea, Tonic, Bitter Lemon, Tangerine Soda, Ginger Soda, Local Energy Drink, Ayran, Kefir, Turnip, Orange, Peach, Cherry, Apple, Pineapple, Tomato, Milkshake varieties</p> <p><b>Hot Drinks:</b> Filter Coffee, Espresso, Cappuccino, Latte, Turkish Coffee, Turkish Tea, Herbal Teas, Hot Chocolate</p> <p><b>Squeezed fruit juices:</b> Three (3) types fresh fruit and vegetable juices.</p>	A LA CARTE RESTAURANTS	✓
<p><b>Wine:</b> SUVLA (White, Red, Rose)</p> <p><b>Sparkling Wine:</b> Amor (White, Rose)</p> <p><b>Aperitif + Digestif + Bitters:</b> Bianco Vermouth, Dry Vermouth, Sweet Vermouth, Grappa, Sake, Campari, Aperol, Aperitivo, Jägermeister, Fernet Branca, Ramazzotti Amaro</p> <p><b>Beer:</b> Efes Pilsen, Bomonti, Beck's, Budweiser, Nonalcoholic Beer</p> <p><b>Vodka:</b> Absolut, Gilbey's, Smirnoff, Russian Standard, Zubrowka Bison Grass, Belvedere</p> <p><b>Rum:</b> Captain Morgan White, Captain Morgan Gold, Bacardi, Havana Club 3 years old, Janeiro Cachaça</p> <p><b>Gin:</b> Gilbey's, Gordon's, Gordon's Pink, Beefeater, Beefeater Strawberry, Tanqueray, Tanqueray Flor De Sevilla, Bombay Sapphire</p> <p><b>Tequila:</b> Sierra, Olmeca Silver, Olmeca Gold, Olmeca Dark Chocolate</p> <p><b>Raki:</b> Efe Göbek, Efe Gold, Efe Yaş Üzüm, Yeni Rakı, Yeni Rakı Yeni Series, Yeni Rakı Ala, Yeni Rakı Ustalar Mixture, Yeni Rakı Long Brew, Tekirdağ, Tekirdağ Altın Series, Tekirdağ Roasted Anise, Kulüp, Altınbaş, Sarı Zeybek, Mercan, Beylerbeyi Göbek</p> <p><b>Whisky:</b> Vat 69, Bells, Ballantine's Finest, J&amp;B Rare, JW Red Label, JW Black Label, JW Double Black, JW Gold Label, JW 18 years old, Famous Grouse, Dimple Golden Selection, Chivas Regal 12 Years Old, Chivas Regal 15 Years Old, Chivas Regal 18 Years Old, Monkey Shoulder, Glenlivet Founder's Reserve(SINGLE MALT), Singleton 12(SINGLE MALT), Cardhu(SINGLE MALT), Glenmorangie 10 Original(SINGLE MALT), Glenmorangie X(SINGLE MALT), Ardbeg Wee Beastie(SINGLE MALT), Jim Beam, Bulleit Bourbon, Jack Daniel's, Gentleman Jack, Jack Daniel's Apple, Jack Daniel's Fire, Jameson, Jameson Caskmates</p> <p><b>Brandy:</b> Sorau Brandy, Napoleon, ST Remy VSOP, Martell VS</p> <p><b>Liquor:</b> Irish Cream, Peach, Mint, Coffee, Orange, Orange, Bitter Almond, Coconut, Tropical, Limoncello, Gum Drop, Maraska Cherry</p> <p><b>Soft Drinks:</b> Coca Cola, Coca Cola Zero, Fanta, Sprite, Iced Tea, Tonic, Bitter Lemon, Tangerine Soda, Ginger Soda, Local Energy Drink, Ayran, Kefir, Turnip, Orange, Peach, Cherry, Apple, Pineapple, Tomato, Milkshake varieties</p> <p><b>Hot Drinks:</b> Filter Coffee, Espresso, Cappuccino, Latte, Turkish Coffee, Turkish Tea, Herbal Teas, Hot Chocolate</p> <p><b>Squeezed fruit juices:</b> Three (3) types fresh fruit and vegetable juices.</p>	MAIN RESTAURANTS	✓



## GENERAL BEVERAGE CONCEPT

BEVERAGE LIST	PLACE	FREE
<p><b>Wine:</b> SUVLA (White, Red, Rose)</p> <p><b>Sparkling Wine:</b> Amor (White, Rose)</p> <p><b>Aperitif + Digestif + Bitters:</b> Bianco Vermouth, Dry Vermouth, Sweet Vermouth, Grappa, Sake, Campari, Aperol, Aperitivo, Jägermeister, Fernet Branca, Ramazzotti Amaro</p> <p><b>Beer:</b> Efes Pilsen, Bomonti, Beck's, Budweiser, Nonalcoholic Beer</p> <p><b>Vodka:</b> Absolut, Gilbey's, Smirnoff, Russian Standard, Zubrowka Bison Grass, Belvedere</p> <p><b>Rum:</b> Captain Morgan White, Captain Morgan Gold, Bacardi, Havana Club 3 years old, Janeiro Cachaça</p> <p><b>Gin:</b> Gilbey's, Gordon's, Gordon's Pink, Beefeater, Beefeater Strawberry, Tanqueray, Tanqueray Flor De Sevilla, Bombay Sapphire</p> <p><b>Tequila:</b> Sierra, Olmeca Silver, Olmeca Gold, Olmeca Dark Chocolate</p> <p><b>Raki:</b> Efe Göbek, Efe Gold, Efe Yaş Üzüm, Yeni Raki, Yeni Raki Yeni Series, Yeni Raki Ala, Yeni Raki Ustalar Mixture, Yeni Raki Long Brew, Tekirdağ, Tekirdağ Altın Series, Tekirdağ Roasted Anise, Kulüp, Altınbaş, Sarı Zeybek, Mercan, Beylerbeyi Göbek</p> <p><b>Whisky:</b> Vat 69, Bells, Ballantine's Finest, J&amp;B Rare, JW Red Label, JW Black Label, JW Double Black, JW Gold Label, JW 18 years old, Famous Grouse, Dimple Golden Selection, Chivas Regal 12 Years Old, Chivas Regal 15 Years Old, Chivas Regal 18 Years Old, Monkey Shoulder, Glenlivet Founder's Reserve(SINGLE MALT), Singleton 12(SINGLE MALT), Cardhu(SINGLE MALT), Glenmorangie 10 Original(SINGLE MALT), Glenmorangie X(SINGLE MALT), Ardbeg Wee Beastie(SINGLE MALT), Jim Beam, Bulleit Bourbon, Jack Daniel's, Gentleman Jack, Jack Daniel's Apple, Jack Daniel's Fire, Jameson, Jameson Caskmates</p> <p><b>Brandy:</b> Sorau Brandy, Napoleon, ST Remy VSOP, Martell VS</p> <p><b>Liquor:</b> Irish Cream, Peach, Mint, Coffee, Orange, Orange, Bitter Almond, Coconut, Tropical, Limoncello, Gum Drop, Maraska Cherry</p> <p><b>Soft Drinks:</b> Coca Cola, Coca Cola Zero, Fanta, Sprite, Iced Tea, Tonic, Bitter Lemon, Tangerine Soda, Ginger Soda, Local Energy Drink, Ayran, Kefir, Turnip, Orange, Peach, Cherry, Apple, Pineapple, Tomato, Milkshake varieties</p> <p><b>Hot Drinks:</b> Filter Coffee, Espresso, Cappuccino, Latte, Turkish Coffee, Turkish Tea, Herbal Teas, Hot Chocolate</p> <p><b>Squeezed fruit juices:</b> Three (3) types fresh fruit and vegetable juices.</p>	ALL GENERAL BARS (Except POOL BAR, PÂTISSERIE and PA&CO)	✓
<p><b>Wine:</b> SUVLA white, red, rose &amp; white, rose sparkling wine</p> <p><b>Beer:</b> Efes Pilsen</p> <p><b>Soft Drinks:</b> Coca Cola, Coca Cola Zero, Fanta, Sprite, Iced Tea, Tonic, Bitter Lemon, Tangerine Soda, Ginger Soda, Local Energy Drink, Ayran, Kefir, Turnip, Orange, Peach, Cherry, Apple, Pineapple, Tomato, Milkshake varieties</p> <p><b>Hot Drinks:</b> Espresso, Cappuccino, Latte, Turkish Coffee, Turkish Tea, Herbal Teas</p> <p>Squeezed Fruit Juices: Fresh Orange Juice</p>	POOL BAR	✓
<p><b>Soft Drinks:</b> Coca Cola, Coca Cola Zero, Fanta, Sprite, Iced Tea, Tonic, Bitter Lemon, Tangerine Soda, Ginger Soda, Local Energy Drink, Ayran, Kefir, Turnip, Orange, Peach, Cherry, Apple, Pineapple, Tomato, Milkshake varieties</p> <p><b>Hot Drinks:</b> Espresso, Cappuccino, Latte, Turkish Coffee, Turkish Tea, Herbal Teas</p> <p>Squeezed Fruit Juices: Fresh Orange Juice</p>	PÂTISSERIE	✓
<p><b>Soft Drinks:</b> Coca Cola, Coca Cola Zero, Fanta, Sprite, Iced Tea, Tonic, Bitter Lemon, Tangerine Soda, Ginger Soda, Local Energy Drink, Ayran, Kefir, Turnip, Orange, Peach, Cherry, Apple, Pineapple, Tomato, Milkshake varieties</p> <p><b>Hot Drinks:</b> Espresso, Cappuccino, Latte, Turkish Coffee, Turkish Tea, Herbal Teas</p>	PA&CO	✓
<p><b>Wine:</b> SUVLA white, red, rose &amp; white, rose sparkling wine</p> <p><b>Draft Beer:</b> Efes Pilsen</p> <p><b>Soft Drinks:</b> Water, Soda, Nonalcoholic Beer, Other Soft Drinks</p>	PIER BAR	✓

**Important Note:** Import availability of some beverage brands during the season and/or the ability of the supplier company to provide them may cause a change in the beverage brands.

Lobby Bar



Wine Cellar



PA&CO Coffee House





## POOLS & AQUAPARK

### POOLS

	Heating	Fresh Water	Pool Sunbed	Depth (cm)	Area (m <sup>2</sup> )
Outdoor Pool / Main	✓	✓	✓	140	1160
Outdoor Pool / Aquapark	✓	✓	✓	120	85
Outdoor Pool / Aquapark	✓	✓	✓	120	68
Outdoor Pool / Select Villa		✓	✓	140	630
Outdoor Pool / Select Villa		✓	✓	140	583
Outdoor Pool / Select Villa		✓	✓	140	254
Outdoor Pool / Select Villa		✓	✓	140	142
Outdoor Pool / Deluxe Villa	✓	✓	✓	140	44
Outdoor Pool / Presidential Villa	✓	✓	✓	140	44
Outdoor Pool / Child	✓	✓	✓	35	16
Outdoor Jacuzzi	✓	✓	✓	100	16
Indoor Pool (half olympic)	✓	✓	✓	140	270
Indoor Kids Pool	✓	✓	✓	35	30
Indoor Jacuzzi	✓	✓	✓	90	16

\* Umbrellas, sun loungers and beach towels at the pools and on the beach.

\* Pool temperature may vary according to the season and weather conditions.

\*The main outdoor pool, the kids outdoor pool and the outdoor jacuzzi heating system will be working until 15.11 and from 15.03



## AQUAPARK

	Min. Age	Min Height (cm)	Level	Depth (cm)
Aqua Tube I	12	120	Medium	120
Aqua Tube II	10	120	Medium	110
Black Hole	12	120	Hard	120
Wide Slide	10	120	Easy	110
Free Fall	10	120	Hard	110

\* Aquapark is open between 10:00 - 12:00 / 14:00 - 17:30 Hours.

\* All slides in the aquapark have age and height restrictions for your safety.

Select Pool



Child Pool



Indoor Pool





# ENTERTAINMENT, ACTIVITIES AND SPORTS

## Places

- Areas of activity
- Outdoor disco
- Martini Lounge
- Pool, pool area and beach
- Fitness center
- Fitness area
- Tennis and basketball court
- Papy Kids club
- Papy Kids Sports Academy
- Dock

## Entertainment

- Professional Dance Shows
- Aerobatics Shows
- Musical Shows
- Themed Parties
- Outdoor Disco

- Festivals
- Live music
- Karaoke
- Piano Concert
- Open air cinema (until 01.10)

## Activities

- Boccia
- Darts
- Beach Volleyball
- Water ball
- Pool Games (until 31.10)
- Air rifle
- Snack Games
- Sjouelen
- Javelot
- Bingo
- Various Tournaments

- Ping pong
- Pinball
- Tennis
- Badminton

## Sports

- For children enrolled in the Papy Kids Sports Academy; Football, Swimming, Tennis and Golf Lessons
- Current fitness trends and complementary programs designed with trainers at Fit Club.
- Private lessons are taught by expert instructors who are certified in their fields.

Aqua Fitness



Beach Volleyball



Amphitheater





## PAPY KIDS CLUB

### Places

- Cinema Room
- Lego Room
- Baby Playroom
- Baby Sleep Room
- Baby Care Room
- Football Field
- Outdoor Game Area
- Art Workshop
- Hobby Workshop
- Young Room

### Entertainment

- Balloon Shows
- Wizard Shows
- Clown Shows
- Cinema
- Mini Disco
- Children's Festival
- Face Painting

### Activities

- Pool Games
- Boccia
- Water Polo
- Football
- Table Tennis
- Lego
- PlayStation
- Dart
- Mini Bowling

### Art Workshop

- Canvas Painting
- Plaster Work
- Origami
- Jewelry Making
- Toy Making
- Wood Painting
- Bead Workshop

### Sports

- Tennis
- Swimming
- Football
- Golf
- Yoga

### Theme Days

- Cookie Day
- Native American Day
- Pirate Day
- Olympics Day

Football



Lego Room



Bubble Activity





## PAPY KIDS SPORTS ACADEMY (until 31.10)

### FOOTBALL

Exercise will be provided through comprehensive programs such as technical and conditioning training with professional trainers on the grass field, tactical studies for football strategy, friendly matches between specified age groups.

- Free group lessons are given 6 days a week for 2 age groups, 4-7 and 8-12.
- 4-7 age group lesson hours are 10:30-11:30
- 8-12 age group lesson hours are 16:00-17:00
- Special lessons hours are 45 €.
- Lessons are 50 minutes.



### SWIMMING

Lessons are conducted in our hotel swimming pools under the supervision of trained instructors. Swimming and breathing exercises will be done in different styles and at different levels (beginner, intermediate and advanced) according to the abilities and the experience level of each student.

- Group lessons twice a week are given free of charge under the supervision of families.
- Special lessons hours are 45 €.
- Lessons are 50 minutes.



### TENNIS

Coordination and conditioning trainings, technical exercises and friendly matches will be organized with professional equipment on the tennis courts on the tartan floor.

- Group lessons twice a week are given free of charge under the supervision of families.
- Special lessons hours are 45 €.
- Lessons are 50 minutes.



### GOLF

Lessons are given by TPGA (Turkish Professional Golfers Association) certified trainers at Fit Swing Academy located at Montgomerie Golf Course.

- Children 10-14 years
- 55 Euro (per person in group lessons) / Lesson duration 60 minutes / Transfer included in the price
- Group lessons are held twice weekly.
- Dress Code: Sport Clothes and Sports Shoes
- Lesson Start Time: 10:00
- Transfer price included





## FITNESS CENTER

Opening-Closing Hours Every day 07:00- 19:00 (15+)

### Weight Training

- Leg Curl
- Leg Press
- Adductor-Abductor
- Leg Extension
- Chest Press
- Shoulder Press
- Bench Press
- Smith Machine
- Abdominal Crunch Machine
- Scott Curl Bench
- Leg Raise Abs Station
- Hyperextension
- Abdominal Crunch Bench
- Dumbbells (2Kg to 40Kg)
- Medicine Balls
- Kettle Bells
- Z Bar
- Barbells

- Adjustable Bench
- Flat Bench
- Utility Bench
- Abdominal Bench

### Cable Multi Station:

- Dual Lat Pull Down
- Outrigger Crossover
- Dual Row
- Triceps Pushdown

### Cardio

- Treadmill
- Elliptical Cross-Trainer
- Lifecycle Vertical
- Lifecycle Horizontal

### Functional Training

- TRX
- Kettlebells
- Medicine Balls
- Swiss Ball
- Mat
- Step Board
- Skipping Rope
- Exercise Elastic Band
- Wheel Roller

### Personal Training

- Fitness
- Bodybuilding
- TRX
- Pilates
- Yoga
- Abs
- Hit





## FIT CLUB & SPECIAL LESSONS

For adults accompanied by certified trainers in their field  
free and paid fitness classes.

### FIT CLUB

**YOGA:** Hatha Yoga, Ashtanga Yoga

**PILATES:** Matwork, Ball Workout, Resistance Band Workout, Stick Workout, Ring Workout, Foam Roll Workout, Stretching, Body Art

**CARDIO:** Zumba, Step Aerobic, Jumping Fitness, Kangoo Jump

**AQUA WORKOUT:** Aqua Gym, Aqua Fitness, Aqua Bike, Aqua Jump, Aqua Zumba

**BODY WORKOUT:** Lower Body Workout, Abs, Full Body Workout, Circle Workout, Tabata, Fat Burn

### PRIVATE LESSONS

#### SWIMMING / 60 mn - 45€

Exercises will be performed in different styles and suitable for all levels, under the supervision of instructors, in pools suitable for training.

#### TENNIS / 60 mn - 45€

Tennis lessons are given to athletes of all levels with professional equipment accompanied by instructors.

#### PERSONEL TRAINING 60 mn - 45€

Classic Bodybuilding, Strength Classes, Metcon, HIIT. Private lessons with fitness instructors.

#### GOLF / 60 mn - 60€

Training will be given by TPGA (Turkish Professional Golfers Association) certified trainers at Fit Swing Academy. Lessons will take place at Montgomerie Golf Course.

Golf



Personel Training



Swimming







# PAPILLON SPORT CENTER

## Social Facility

- 4 60 m<sup>2</sup> Changing Rooms
- 4 40 m<sup>2</sup> Meeting Halls
- 2 11 m<sup>2</sup> Referee Rooms.
- 79 m<sup>2</sup> Lobby area.
- 80 m<sup>2</sup> Food and beverage unit and terrace for watching the match

## Pitches

- A total of 36 projectors, both wide and narrow angles, with 2000 watts of power in Field A with Metal Halide bulbs.
- In Fields B, C, D, E with Metal Halide bulbs, 2000 watts of 2000 watt projectors, wide and narrow angle, 44 projectors in each field.

- 800 kVA Generator for power cuts.
- A - Field: 95 x 65 m.
- B, C, D, E - Fields: 105 x 68 m.
- F - Field: 70 x 45 m.



## Papillon Drainage System

- Grass
- Sand / 0
- Gravel-Sand / 0-7
- Gravel / 7-15
- Drainpipe Coarse
- Gravel / 15-30

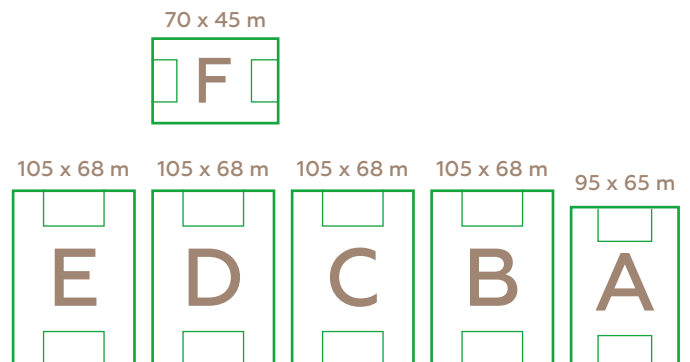



# REBORN SPA & WELLNESS

Open every day between 09:00 - 19:30.

Massages in different disciplines are offered at the 1650 m<sup>2</sup> Reborn Spa in Papillon Ayscha. Services include personalized packages, beauty rituals and children's spa treatments.

Turkish Bath, sauna, steam bath, shower, dressing room and listening areas are free to use. Massage, treatments, beauty treatments and other services are available for an extra charge.

- Towel and hammam towels are provided to all guests who use the spa.

- Shampoo, conditioner and shower gel - available on request.

- Bathrobes, Slippers – provided to guests of the spa at an additional charge.

### Total Wellness - 572 m<sup>2</sup>

- Reception area
- Sauna
- Steam Room
- Turkish Bath
- Massage Rooms
- Beauty Care Room
- Manicure & Pedicure Room
- VIP Room

### Paid Services

- Massages
- Skin and Body care
- VIP Section and spa

Sauna



Turkish Bath



Massage VIP



# MEETINGS and CONFERENCES

## HALLS

Place	Area m <sup>2</sup>	Size (m)	Height (m)	Theatre	Class	U Layout	Banquet
Gordion I	223	13.5 x 16.5	4.2	320	120	48-70	160
Gordion II	182	11 x 16.5	4.2	240	110	48-70	140
Gordion III	182	11 x 16.5	4.2	240	110	48-70	140
Gordion I-II	405	24.5 x 16.5	4.2	480	200	-	310
Gordion II-III	363	22 x 16.5	4.2	420	185	-	290
Gordion I-II-III	578	35 x 16.5	4.2	750	350	-	450
Gordion IV	53	7.5 x 7	4.2	30	24	25	-
Gordion V	84	15 x 5.6	3.2	90	40	35	-
Nautilus I	48	6.68 x 7.25	3.4	48	24	18	30
Nautilus II	54	7.25 x 7.25	3.4	48	24	18	30
Nautilus III	54	7.25 x 7.25	3.4	48	24	18	30
Nautilus IV	54	7.25 x 7.25	3.4	48	24	18	30
Nautilus I-II	102	14.2 x 7.25	3.4	108	54	36	50
Nautilus III-IV	108	15 x 7.25	3.4	108	54	36	50

Gordion I-II-III



Nautilus

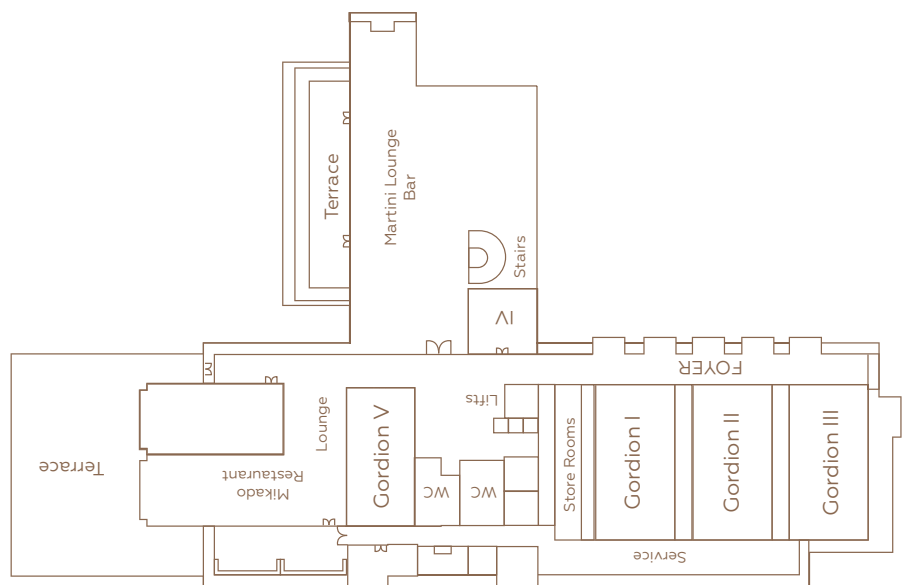

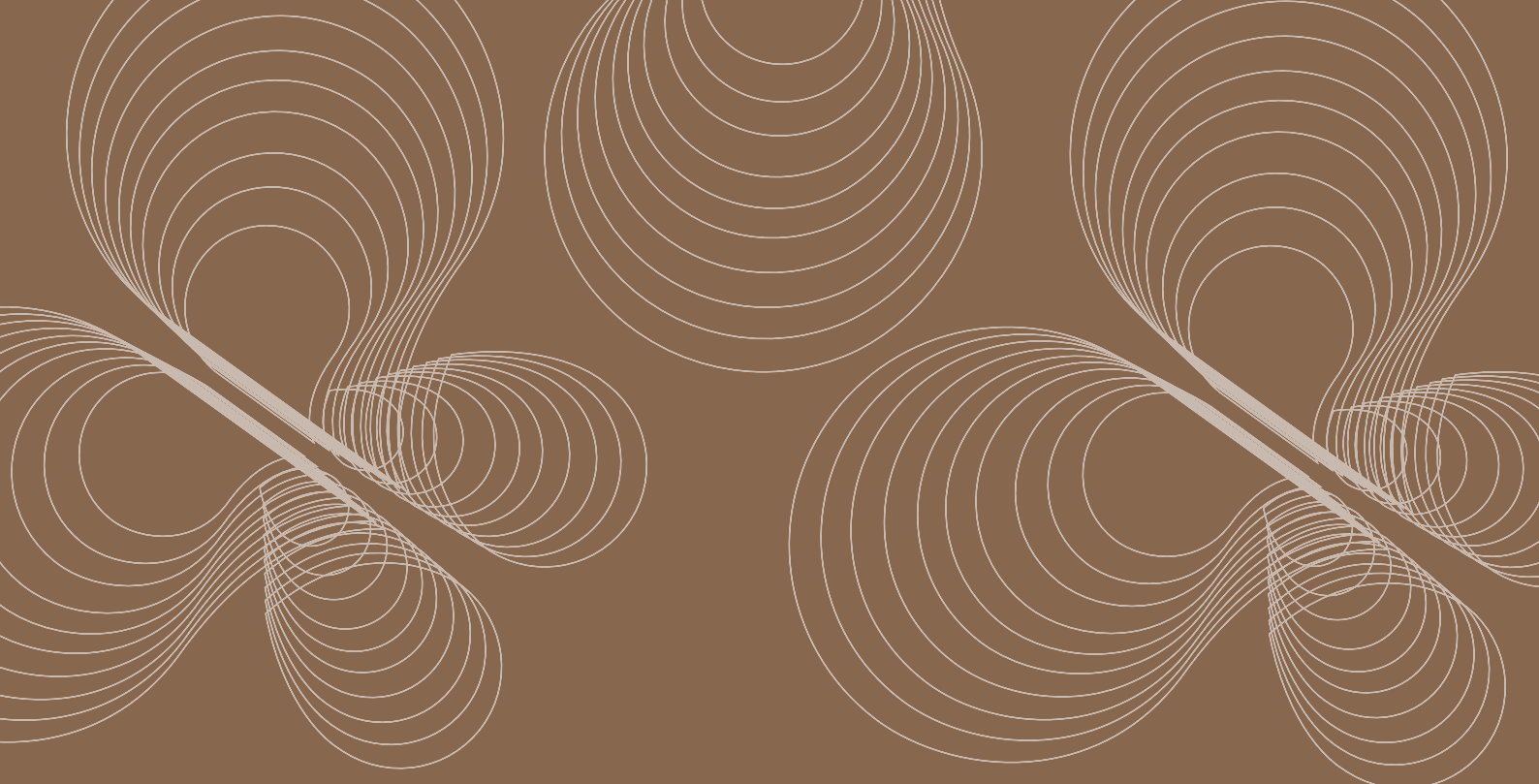

Welcome Back



**PAPILLON**  
HOTELS